

Appendix F:
SEPP No. 14 Maps

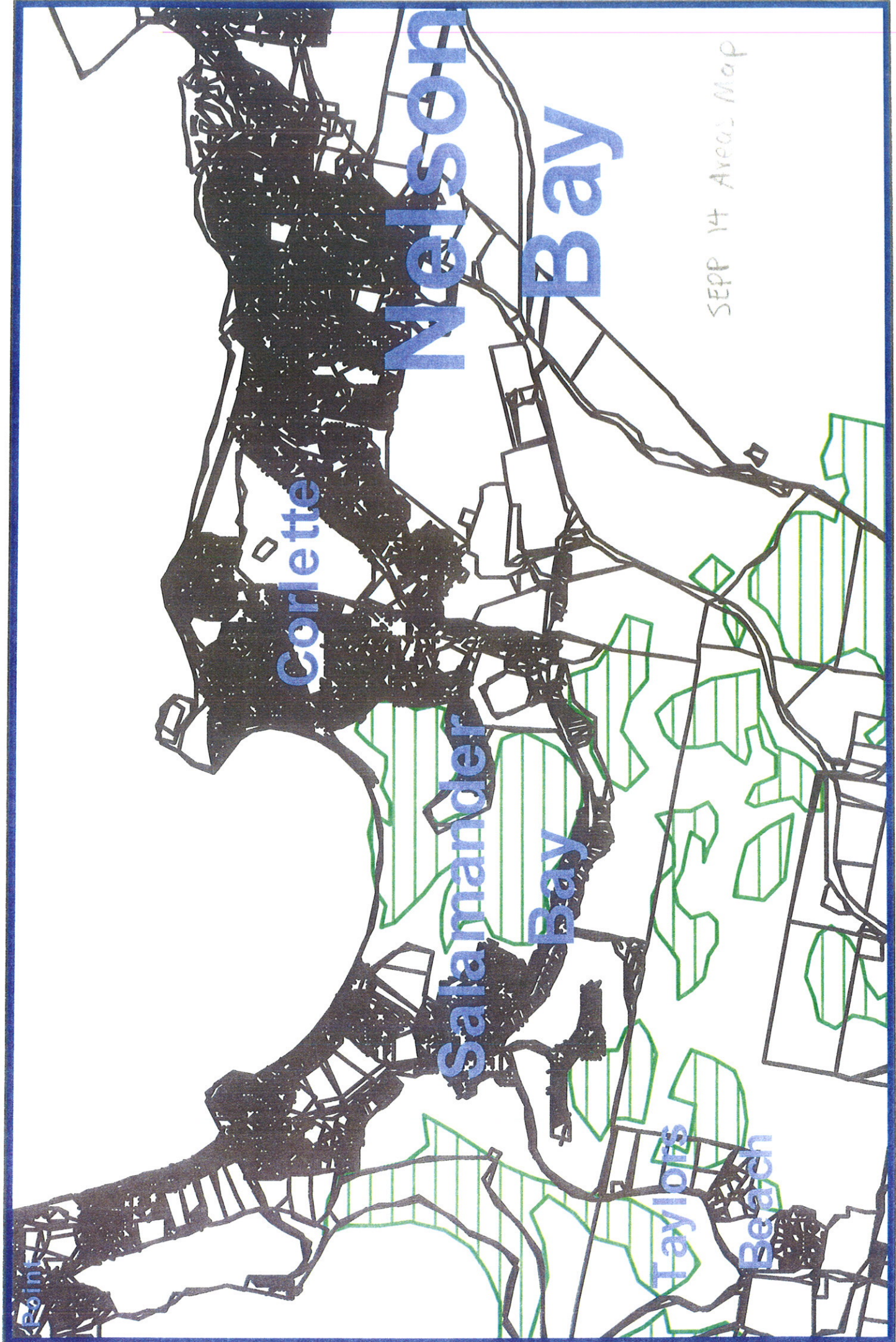

SEPP 14 Areas Map

Wilson Bay

Corlette

Salamander Bay

Taylors Beach

Point

- Increase weeds and feral animals – new road will facilitate increased access of these into the SEPP 14 area.
- Increase illegal dumping – the road will enable illegal dumping and litter to easily be deposited into the SEPP 14 area.
- Increased opportunity for arson in and adjacent to the SEPP 14 area.
- Destruction of wetland on the development site will lead to increased competition pressure for species reliant on the wetland.
- By totally surrounding the SEPP 14 wetland with urban development, there will be no available refuge for these species or ecosystem when sea level and the water table rise as a result of climate change. There will also be no refuge from bushfires.

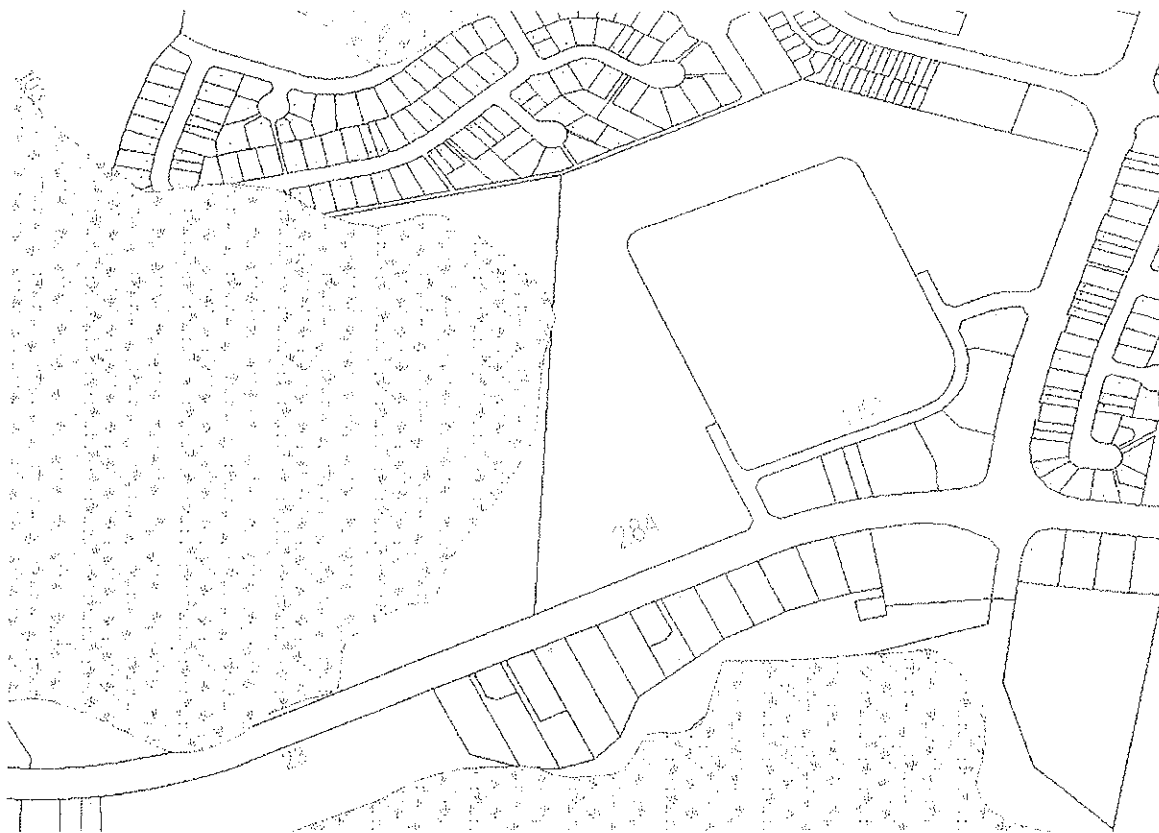

(Figure 1) SEPP 14 wetland boundary - provided by the Department of Planning July 2010